

Permit Application and Report of Changes

Current License Number 03-13973
All Answers Must Be Printed in Black Ink or Typewritten
 Local License Fee \$ _____

1. Applicant is a		Present License Number
<input type="checkbox"/> Corporation <input type="checkbox"/> Individual <input type="checkbox"/> Partnership..... <input checked="" type="checkbox"/> Limited Liability Company		03-13973
2. Name of Licensee <u>PIN DECK 1, LLC</u>	3. Trade Name <u>PINDUSTRY</u>	
4. Location Address <u>7939 E. ARAPAHOE ROAD, GREENWOOD VILLAGE, CO 80</u>		
City <u>GREENWOOD VILLAGE</u>	County <u>ARAPAHOE</u>	ZIP <u>80112</u>

SELECT THE APPROPRIATE SECTION BELOW AND PROCEED TO THE INSTRUCTIONS ON PAGE 2.

Section A – Manager reg/change	Section C
• License Account No. _____ <input type="checkbox"/> Manager's Registration (Hotel & Restr.).....\$75.00 <input type="checkbox"/> Manager's Registration (Tavern).....\$75.00 <input type="checkbox"/> Manager's Registration (Lodging & Entertainment).....\$75.00 <input type="checkbox"/> Change of Manager (Other Licenses pursuant to section 44-3-301(8), C.R.S.) NO FEE	<input type="checkbox"/> Retail Warehouse Storage Permit (ea).....\$100.00 <input type="checkbox"/> Wholesale Branch House Permit (ea)..... 100.00 <input type="checkbox"/> Change Corp. or Trade Name Permit (ea) 50.00 <input type="checkbox"/> Change Location Permit (ea)..... 150.00 <input checked="" type="checkbox"/> Change, Alter or Modify Premises \$150.00 x <u>2</u> Total Fee <u>300.00</u>
Section B – Duplicate License • Liquor License No. _____ <input type="checkbox"/> Duplicate License \$50.00	<input type="checkbox"/> Addition of Optional Premises to Existing H/R \$100.00 x _____ Total Fee _____ <input type="checkbox"/> Addition of Related Facility to an Existing Resort or Campus Liquor Complex \$160.00 x _____ Total Fee _____ <input type="checkbox"/> Campus Liquor Complex Designation No Fee

Do Not Write in This Space – For Department of Revenue Use Only

Date License Issued	License Account Number	Period

The State may convert your check to a one time electronic banking transaction. Your bank account may be debited as early as the same day received by the State. If converted, your check will not be returned. If your check is rejected due to insufficient or uncollected funds, the Department of Revenue may collect the payment amount directly from your bank account electronically.

TOTAL AMOUNT DUE \$ _____ .00

Instruction Sheet

For All Sections, Complete Questions 1-4 Located on Page 1

Section A

To Register or Change Managers, check the appropriate box in section A and complete question 8 on page 4. Proceed to the Oath of Applicant for signature. Submit to State Licensing Authority for approval.

Section B

For a Duplicate license, be sure to include the liquor license number in section B on page 1 and proceed to page 4 for Oath of Applicant signature.

Section C

Check the appropriate box in section C and proceed below.

- 1) **For a Retail Warehouse Storage Permit**, go to page 3 complete question 5 (be sure to check the appropriate box). Submit the necessary information and proceed to page 4 for Oath of Applicant signature. Submit to State Licensing Authority for approval.
- 2) **For a Wholesale Branch House Permit**, go to page 3 and complete question 5 (be sure to check the appropriate box). Submit the necessary information and proceed to page 4 for Oath of Applicant signature. Submit to State Licensing Authority for approval.
- 3) **To Change Trade Name or Corporation Name**, go to page 3 and complete question 6 (be sure to check the appropriate box). Submit the necessary information and proceed to page 4 for Oath of Applicant signature. Retail Liquor License submit to Local Liquor Licensing Authority (City or County). Manufacturer, Wholesaler and Importer's Liquor Licenses submit to State Liquor Licensing Authority.
- 4) **To modify Premise**, go to page 4 and complete question 9. Submit the necessary information and proceed to page 4 for Oath of Applicant signature. Retail Liquor License submit to Local Liquor Licensing Authority (City or County). Manufacturer, Wholesaler and Importer's Liquor Licenses submit to State Liquor Licensing Authority.
- 5) **For Optional Premises** go to page 4 and complete question 9. Submit the necessary information and proceed to page 4 for Oath of Applicant signature. Retail Liquor License submit to Local Liquor Licensing Authority (City or County).
- 6) **To Change Location**, go to page 3 and complete question 7. Submit the necessary information and proceed to page 4 for Oath of Applicant signature. Retail Liquor License submit to Local Liquor Licensing Authority (City or County). Manufacturer, Wholesaler and Importer's Liquor Licenses submit to State Liquor Licensing Authority.
- 7) **Campus Liquor Complex Designation**, go to page 4 and complete question 10. Submit the necessary information and proceed to page 4 for Oath of Applicant signature.
- 8) **To add another Related Facility** to an existing Resort or Campus Liquor Complex, go to page 4 and complete question 11.

Storage Permit	<p>5. Retail Warehouse Storage Permit or a Wholesalers Branch House Permit</p> <p><input type="checkbox"/> Retail Warehouse Permit for:</p> <p style="margin-left: 20px;"><input type="checkbox"/> On-Premises Licensee (Taverns, Restaurants etc.)</p> <p style="margin-left: 20px;"><input type="checkbox"/> Off-Premises Licensee (Liquor stores)</p> <p><input type="checkbox"/> Wholesalers Branch House Permit</p> <p>Address of storage premise: _____</p> <p>City _____, County _____, Zip _____</p> <p>Attach a deed/ lease or rental agreement for the storage premises. Attach a detailed diagram of the storage premises.</p>								
Change Trade Name or Corporate Name	<p>6. Change of Trade Name or Corporation Name</p> <p><input type="checkbox"/> Change of Trade name / DBA only</p> <p><input type="checkbox"/> Corporate Name Change (Attach the following supporting documents)</p> <p style="margin-left: 20px;">1. Certificate of Amendment filed with the Secretary of State, or</p> <p style="margin-left: 20px;">2. Statement of Change filed with the Secretary of State, <u>and</u></p> <p style="margin-left: 20px;">3. Minutes of Corporate meeting, Limited Liability Members meeting, Partnership agreement.</p> <table border="1" style="width: 100%; border-collapse: collapse;"> <tr> <td style="width: 50%;">Old Trade Name</td> <td style="width: 50%;">New Trade Name</td> </tr> <tr> <td> </td> <td> </td> </tr> <tr> <td>Old Corporate Name</td> <td>New Corporate Name</td> </tr> <tr> <td> </td> <td> </td> </tr> </table>	Old Trade Name	New Trade Name			Old Corporate Name	New Corporate Name		
Old Trade Name	New Trade Name								
Old Corporate Name	New Corporate Name								
Change of Location	<p>7. Change of Location</p> <p>NOTE TO RETAIL LICENSEES: An application to change location has a local application fee of \$750 payable to your local licensing authority. You may only change location within the same jurisdiction as the original license that was issued. Pursuant to 44-3-311(1) C.R.S. Your application must be on file with the local authority thirty (30) days before a public hearing can be held.</p> <p>Date filed with Local Authority _____ Date of Hearing _____</p> <p>(a) Address of current premises _____</p> <p style="margin-left: 20px;">City _____ County _____ Zip _____</p> <p>(b) Address of proposed New Premises (Attach copy of the deed or lease that establishes possession of the premises by the licensee)</p> <p style="margin-left: 20px;">Address _____</p> <p style="margin-left: 20px;">City _____ County _____ Zip _____</p> <p>(c) New mailing address if applicable.</p> <p style="margin-left: 20px;">Address _____</p> <p style="margin-left: 20px;">City _____ County _____ State _____ Zip _____</p> <p>(d) Attach detailed diagram of the premises showing where the alcohol beverages will be stored, served, possessed or consumed. Include kitchen area(s) for hotel and restaurants.</p>								

Change of Manager	<p>8. Change of Manager or to Register the Manager of a Tavern, Hotel and Restaurant, Lodging & Entertainment liquor license or licenses pursuant to section 44-3-301(8).</p> <p>(a) Change of Manager (attach Individual History DR 8404-I H/R, Tavern and Lodging & Entertainment only)</p> <p>Former manager's name _____</p> <p>New manager's name _____</p> <p>(b) Date of Employment _____</p> <p>Has manager ever managed a liquor licensed establishment? Yes <input type="checkbox"/> No <input type="checkbox"/></p> <p>Does manager have a financial interest in any other liquor licensed establishment? Yes <input type="checkbox"/> No <input type="checkbox"/></p> <p>If yes, give name and location of establishment _____</p>
Modify Premises or Addition of Optional Premises or Related Facility	<p>9. Modification of Premises, Addition of an Optional Premises, or Addition of Related Facility</p> <p>NOTE: Licensees may not modify or add to their licensed premises until approved by state and local authorities.</p> <p>(a) Describe change proposed <u>Temp use of Parking area contingent to premises for weekend event</u></p> <p>(b) If the modification is temporary, when will the proposed change:</p> <p>Start <u>06/02/2023</u> (mo/day/year) End <u>06/04/2023</u> (mo/day/year)</p> <p>NOTE: THE TOTAL STATE FEE FOR TEMPORARY MODIFICATION IS \$300.00</p> <p>(c) Will the proposed change result in the licensed premises now being located within 500 feet of any public or private school that meets compulsory education requirements of Colorado law, or the principal campus of any college, university or seminary?</p> <p>(If yes, explain in detail and describe any exemptions that apply) Yes <input type="checkbox"/> No <input checked="" type="checkbox"/></p> <p>(d) Is the proposed change in compliance with local building and zoning laws? Yes <input checked="" type="checkbox"/> No <input type="checkbox"/></p> <p>(e) If this modification is for an additional Hotel and Restaurant Optional Premises has the local authority authorized by resolution or ordinance the issuance of optional premises? <u>N/A</u> Yes <input type="checkbox"/> No <input type="checkbox"/></p> <p>(f) Attach a diagram of the current licensed premises and a diagram of the proposed changes for the licensed premises.</p> <p>(g) Attach any existing lease that is revised due to the modification.</p>
Campus Liquor Complex Designation	<p>10. Campus Liquor Complex Designation</p> <p>An institution of higher education or a person who contracts with the institution to provide food services</p> <p>(a) I wish to designate my existing _____ Liquor License # _____ to a Campus Liquor Complex Yes <input type="checkbox"/> No <input type="checkbox"/></p>
Additional Related Facility	<p>11. Additional Related Facility</p> <p>To add a Related Facility to an existing Resort or Campus Liquor Complex, include the name of the Related Facility and include the address and an outlined drawing of the Related Facility Premises.</p> <p>(a) Address of Related Facility _____</p> <p>(b) Outlined diagram provided Yes <input type="checkbox"/> No <input type="checkbox"/></p>

Oath of Applicant		
I declare under penalty of perjury in the second degree that I have read the foregoing application and all attachments thereto, and that all information therein is true, correct, and complete to the best of my knowledge		
Signature 	Title Culinary Director	Date 2/24/2023
Report and Approval of LOCAL Licensing Authority (CITY / COUNTY)		
The foregoing application has been examined and the premises, business conducted and character of the applicant is satisfactory, and we do report that such permit, if granted, will comply with the applicable provisions of Title 44, Articles 4 and 3, C.R.S., as amended. Therefore, This Application is Approved.		
Local Licensing Authority (City or County)		Date filed with Local Authority
Signature	Title	Date
Report of STATE Licensing Authority		
The foregoing has been examined and complies with the filing requirements of Title 44, Article 3, C.R.S., as amended.		
Signature	Title	Date

CODE PLAN LEGEND

..... ROOFLINE
 - - - - - EXTERIOR WALL
 - - - - - INTERIOR WALL
 - - - - - WINDOW
 - - - - - DOOR
 - - - - - STAIR
 - - - - - ELEVATOR
 - - - - - MECHANICAL
 - - - - - IF

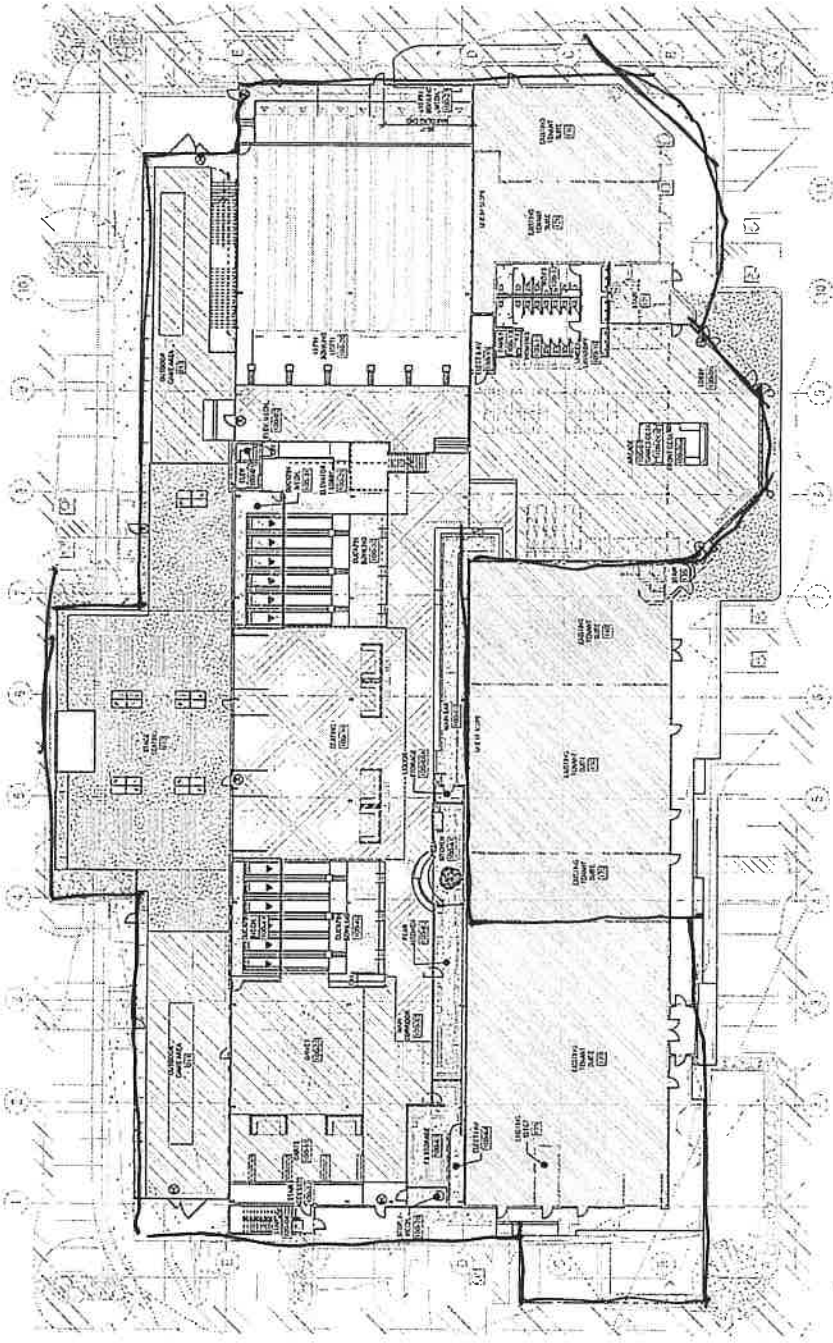

① MAIN LEVEL TI - LIQUOR LICENSING
SCALE: 1/8" = 1'-0"

CURRENT LICENSED PREMISE

STUDIO LEWONACE

12/15/2019
 7939 E ARAPAHOE RD, SUITE 100
 GREENWOOD VILLAGE, CO 80112

PROJECT: PINDUSTRY TI
 DATE: 12/15/2019
 DRAWN BY: [REDACTED]
 CHECKED BY: [REDACTED]
 APPROVED BY: [REDACTED]

PINDUSTRY TI
 7939 E ARAPAHOE RD, SUITE 100
 GREENWOOD VILLAGE, CO 80112

REVISED:
 SHEET 2/4
 FURNISHING
 LIQUOR LICENSING PLAN
 LL1.0
 09.02.2020

STUDIO ELEVATIONS

155 Colorado Ave
 Denver, CO 80202
 P. 303.441.0033

STUDIO ELEVATIONS
 ARCHITECTURE
 155 COLORADO AVE
 DENVER, CO 80202
 P. 303.441.0033

STUDIO ELEVATIONS
 ARCHITECTURE
 155 COLORADO AVE
 DENVER, CO 80202
 P. 303.441.0033

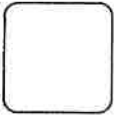
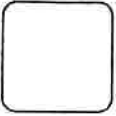

INDUSTRY T1
 7939 E ARAPAHOE RD, SUITE 100
 GREENWOOD VILLAGE, CO 80112

REVISIONS

DATE: 09/02/2020

112.0

PROJECT: INDUSTRY T1

DATE: 09/02/2020

CODE PLAN LEGEND

.....	WALL
---	DOOR
---	WINDOW
---	GLASS
---	FRONT DOOR
---	6"

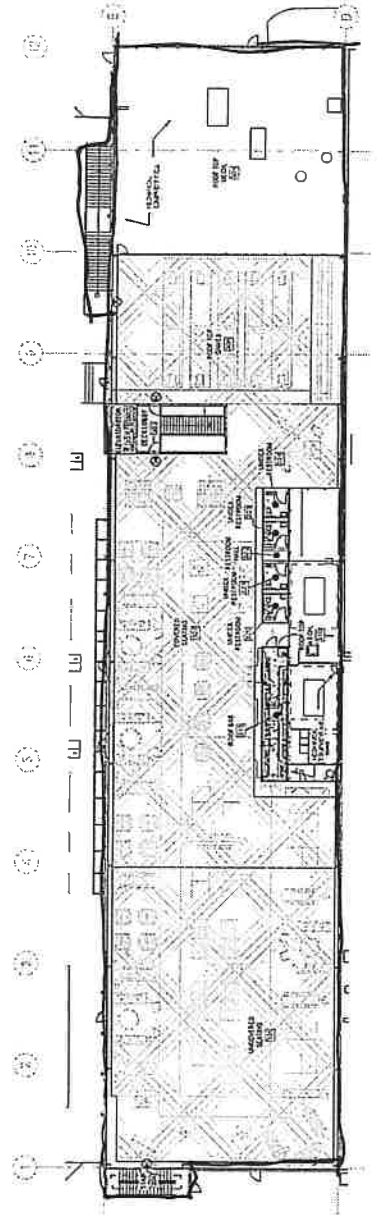

1 FLOOR DECK - LIQUOR LICENSING
 SHEET 101-12

*CURRENT LICENSED
 SKYDECK*

BK

EIGHTH AMENDMENT OF THE FINAL DEVELOPMENT PLAN for GREENWOOD RETAIL PLAZA

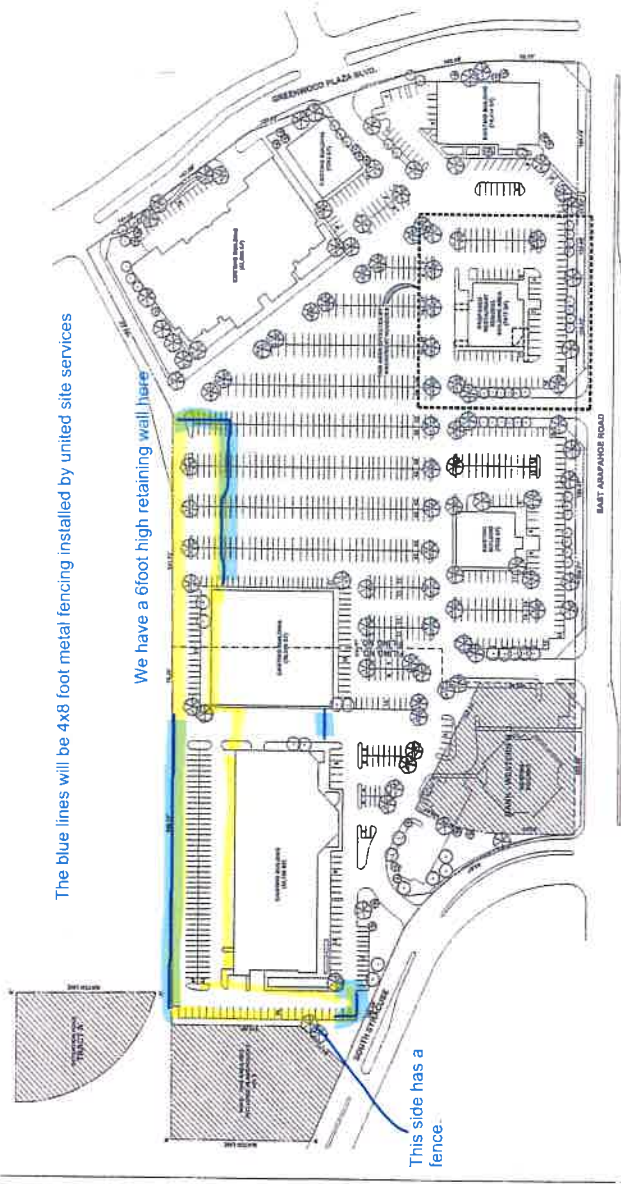

The blue lines will be 4x8 foot metal fencing installed by united site services

We have a 6foot high retaining wall here

This side has a fence.

GREENWOOD RETAIL PLAZA ASSOCIATION, INC.

7343 South Alton Way, Suite 100

Centennial, CO 80112

(303) 779-1800

March 17, 2023

Mr. Chris Collins
Pindustry
7939 E Arapahoe Road
Greenwood Village, CO 80112

Dear Mr. Collins.

This letter is in regard to the request you made about using a portion of the Greenwood Retail Plaza parking and common areas. We hereby grant you, Mr. Chris Collins, permission to use the areas you have marked on the plan of Greenwood Retail Plaza. This property is available to you from 1st June to 6th June. This period marks the validity of the authorization.

We understand you will invite all of the tenants and businesses of Greenwood Retail Plaza, as well as possibly others, to participate in the special event you are planning, for the benefit of the entire center.

Mr. Chris Collins, you are requested to protect and take care of the property. You are required to leave the premises the way you found it.

Sincerely,



Robert A. Koontz
Director

Control Plan

Greenwood Village SummerFest 2023

Hours:

- Friday June 2nd 2:00pm – 10:00pm
 - Music ends at 7:00pm
 - Last call 9:00pm
- Saturday June 3rd 11:00am – 10:00pm
 - Music ends at 7:00pm
 - Last call 9:00pm
- Sunday June 4th 11:00am – 7:00pm
 - Music ends at 6:30pm
 - Last Call at 6:00pm

Boundary:

- 4 foot by 8 foot metal fencing will be used in combination with large retaining walls surrounding the entire space to be used.

Ingress & Egress:

- We will have 3 points of entry and exit for the event
- Each point of entry will have a hired security guard stationed at all times along with 2 employees.

Signage:

- We will have no alcoholic beverage beyond this point signs stationed at all 3 points of exit. We also will post them on all temporary fencing surrounding the space.

Responsible Service:

- We will have a booth set up for id check and wrist band control.
- Wrist bands will be secured to individuals who are 21 years or older. ID's will be checked by TIPS certified employees.
- All alcoholic beverages will be served by TIPS certified employees who have been trained to recognize intoxication.
- We will also have roaming security guards for the event to assist with crowd and alcohol control.